

DOOR SCHEDULE												
DOOR	LOCATION	DOOR			DETAILS				REMARKS	HARDWARE SET		
		SIZE	MATERIAL	TYPE	SWING	INSULATED	HEAD	JAMB			SILL	
D-EM1	ELECTRICAL ROOM	2'-6" x 8'-0" PR	STEEL	B	RHR ACTIVE	YES	3	5	4	STEEL DOOR AND FRAME, STAINLESS STEEL HARDWARE w/ MECHANICAL PUSHBUTTON SECURITY SYSTEM.	D	
D-EM2	VEHICLE BAYS	3'-0" x 7'-0"	STEEL	A	RHR	YES	3	5	4	STEEL DOOR AND FRAME, STAINLESS STEEL HARDWARE w/ MECHANICAL PUSHBUTTON SECURITY SYSTEM.	A	
D-EM3	VEHICLE BAYS	3'-0" x 7'-0"	STEEL	A	LHR	YES	3	5	4	STEEL DOOR AND FRAME, STAINLESS STEEL HARDWARE w/ MECHANICAL PUSHBUTTON SECURITY SYSTEM.	A	
D-EM4	VEHICLE BAYS	14'-0" x 14'-0"	STEEL	D	OH	YES				PROVIDE PAD LOCK HASP THROUGH TRACK ABOVE FLOOR WITH INSULATED PANELS. DOOR SIZE SHOWN IS FOR CLEAR OPENING.	-	
D-EM5	VEHICLE BAYS	14'-0" x 14'-0"	STEEL	D	OH	YES				PROVIDE PAD LOCK HASP THROUGH TRACK ABOVE FLOOR WITH INSULATED PANELS. DOOR SIZE SHOWN IS FOR CLEAR OPENING.	-	
D-EM6	VEHICLE BAYS	14'-0" x 14'-0"	STEEL	D	OH	YES				PROVIDE PAD LOCK HASP THROUGH TRACK ABOVE FLOOR WITH INSULATED PANELS. DOOR SIZE SHOWN IS FOR CLEAR OPENING.	-	
D-EM7	VEHICLE BAYS	14'-0" x 14'-0"	STEEL	D	OH	YES				PROVIDE PAD LOCK HASP THROUGH TRACK ABOVE FLOOR WITH INSULATED PANELS. DOOR SIZE SHOWN IS FOR CLEAR OPENING.	-	
D-EM8	ELECTRICAL ROOM	3'-0" x 7'-0"	STEEL	F	LHR	YES	1	1	4	STEEL DOOR AND FRAME AND STAINLESS STEEL HARDWARE; MIN. 1-HOUR FIRE RATING	E	
D-EM9	STORAGE ROOM	3'-0" x 7'-0"	STEEL	E	LH	YES	1	1	2	STEEL DOOR AND FRAME AND STAINLESS STEEL HARDWARE.	F	
D-EM10	HEATED STORAGE	3'-0" x 7'-0"	STEEL	E	RH	YES	1	1	2	STEEL DOOR AND FRAME AND STAINLESS STEEL HARDWARE.	F	
D-EM11	TOILET ROOM	3'-0" x 7'-0"	STEEL	C	RHR	YES	1	1	2	STEEL DOOR AND FRAME AND STAINLESS STEEL HARDWARE.	G	
D-EM12	MECHANICAL ROOM	3'-6" x 7'-0"	STEEL	F	LH	YES	1	1	4	STEEL DOOR AND FRAME AND STAINLESS STEEL HARDWARE; MIN. 1-HOUR FIRE RATING	E	
D-EM13	ELECTRICAL ROOM	3'-0" x 7'-0"	STEEL	A	LHR	YES	3	5	4	STEEL DOOR AND FRAME, STAINLESS STEEL HARDWARE w/ MECHANICAL PUSHBUTTON SECURITY SYSTEM.	B	

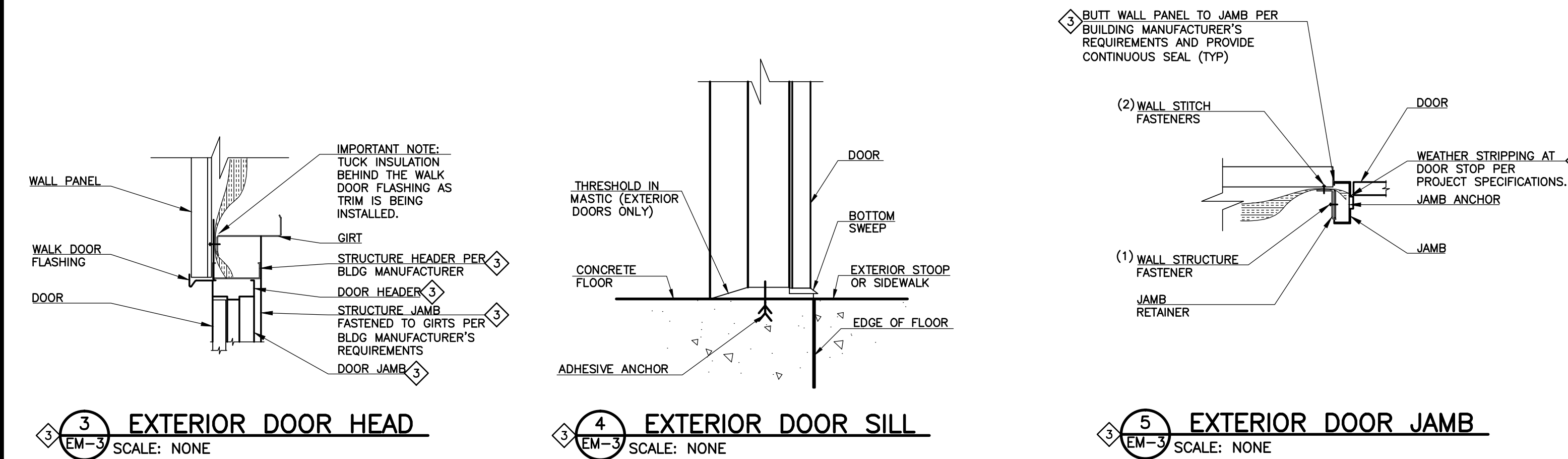

ROOM FINISH SCHEDULE							REMARKS
ROOM	FLOOR	WALLS	CEILING	WALLS	CEILING	WALLS	
	CONCRETE, SEALED	VINYL COMPOSITE TILE w/VINYL COVE BASE	EXPOSED WALL GIRTS AND METAL SIDING	GWB, PAINTED	GWB, PAINTED	BLANKET INSULATION	
ELECTRICAL ROOM						X	DROP CEILING TO BE FINISHED 12'-0" AFF
EXTERIOR BLDG WALLS	X		X				
INTERIOR BLDG WALLS	X		X				
HEATED STORAGE ROOM	X		X	X			CEILING TO BE FINISHED 12'-0" AFF
TOILET ROOM	X	X	X	X			CEILING TO BE FINISHED 12'-0" AFF
STORAGE ROOM	X		X	X			CEILING TO BE FINISHED 12'-0" AFF
MECHANICAL ROOM	X	X	X	X			CEILING TO BE FINISHED 12'-0" AFF
VEHICLE BAYS	X	X	X	X			SOUTH WALL TO HAVE GWB, PAINTED

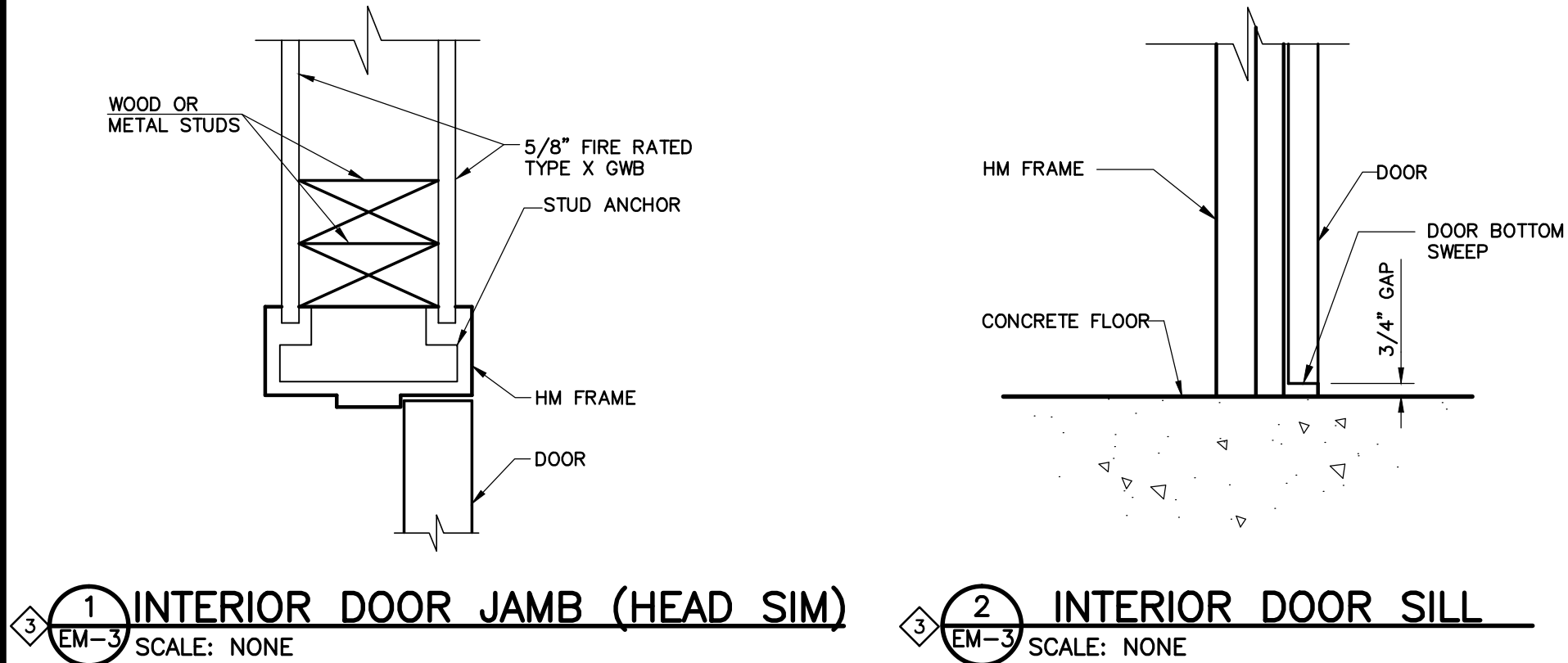
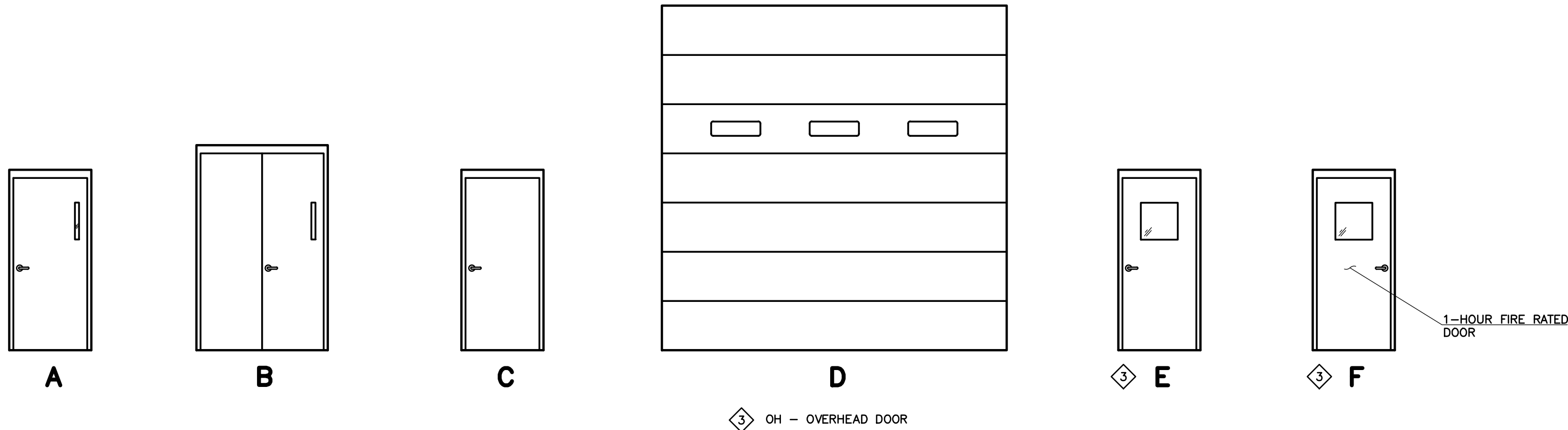
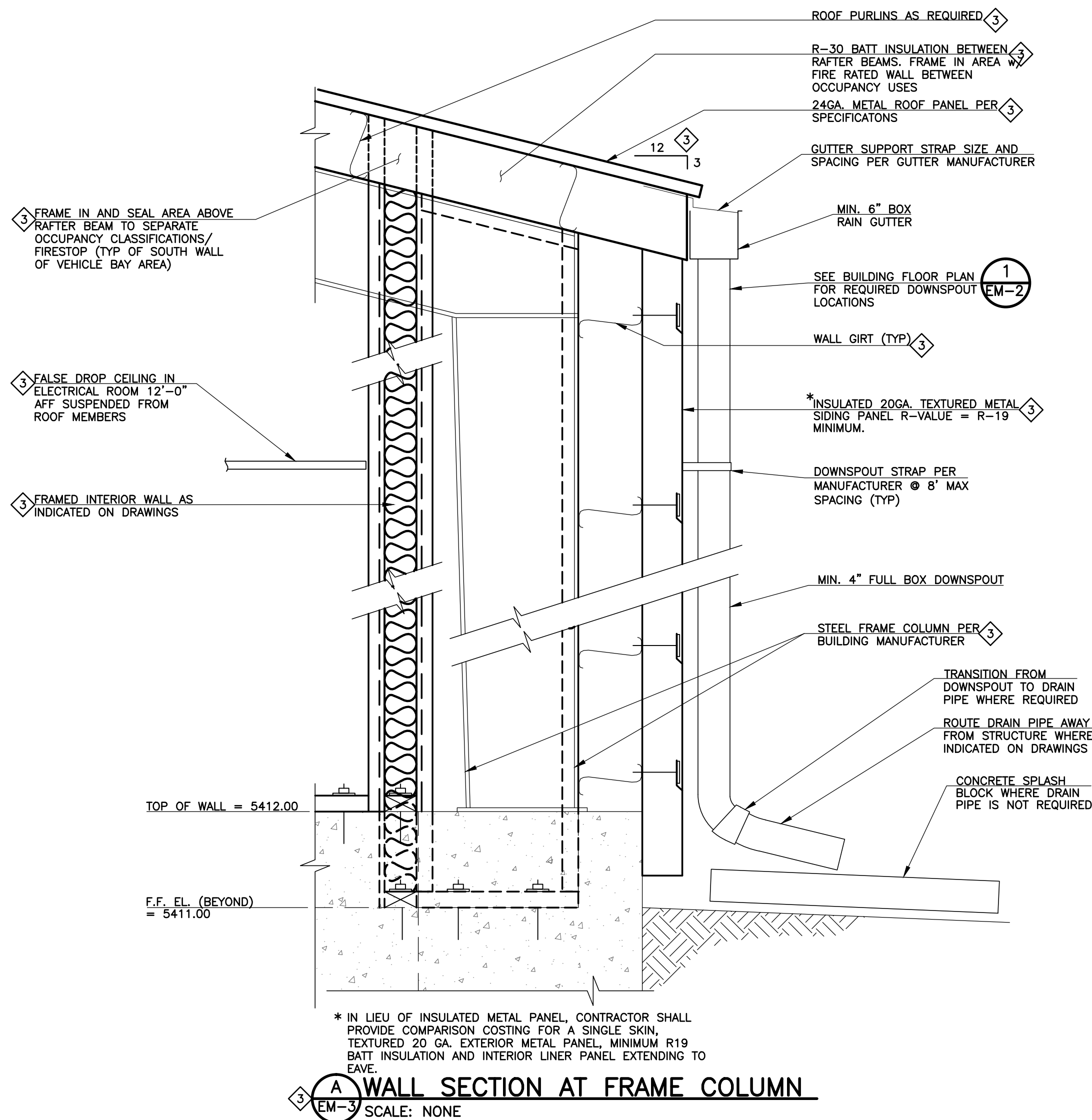

REVISIONS		
NO.	DATE	DESCRIPTION
1	07/28/2011	ISSUED FOR FOUNDATION PERMIT SUBMITTAL TO PPRBD (EQUIP., MAINT. AND STO. BLDG)
2	08/24/2011	ISSUED FOR CONSTRUCTION PER PPRBD (EQUIP., MAINT. AND STO. BLDG)
3	11/23/2011	ISSUED FOR BUILDING PERMIT SUBMITTAL TO PPRBD (EQUIP., MAINT. & STO. BLDG)
4	01/09/2012	ISSUED FOR CONSTRUCTION PER PPRBD BUILDING PERMIT #H3002 (EQUIP., MAINT. & STO. BLDG)

THIS DRAWING IS THE PROPERTY OF GMS, INC., AND IS NOT TO BE RE-PRODUCED, MODIFIED OR USED FOR ANY OTHER PROJECT OR EXTENSION OF THIS PROJECT EXCEPT BY AGREEMENT WITH THIS COMPANY.

ARCHITECTURAL SCHEDULES, SECTIONS AND DETAILS  
HAROLD D. THOMPSON REGIONAL WATER RECLAMATION FACILITY  
LOWER FOUNTAIN METROPOLITAN SEWAGE DISPOSAL DISTRICT

DRAWN: DRF  
DESIGNED: DRF  
CHECKED: RJS  
DATE: JUNE 2011  
PROJECT NO.: 20166.415  
GMS FILE NO.: 2599

GMS, INC.  
CONSULTING ENGINEERS  
611 N. WEBER, SUITE 300  
COLORADO SPRINGS, COLORADO 80903

SHEET  
EM-3  
OF  
-