

GENERAL NOTES:

1. ALL IN SLAB CONDUIT MAY BE PVC WITH COATED GRC ELLS UP THROUGH THE SURFACE OF THE SLAB.
2. ALL CONDUIT SHALL MEET THE PROJECT MANUAL REQUIREMENTS FOR MATERIAL AND INSTALLATION METHODS.

KEYED NOTES:

- ① FLOW CONTROL VALVE ELECTRIC ACTUATOR POWER CONDUIT: (1) 1" C.
- ② FLOW CONTROL VALVE ELECTRIC ACTUATOR SIGNAL CONDUIT: (1) 1" C.
- ③ ELECTROMAGNETIC FLOW METER POWER CONDUIT: (1) 1" C.
- ④ ELECTROMAGNETIC FLOW METER SIGNAL CONDUIT: (1) 1" C.
- ⑤ PUMP POWER CONDUIT: (1) 1-1/2" C. (INSTALL FOR FUTURE PUMP).
- ⑥ PUMP POWER CONDUIT: (1) 1-1/4" C.
- ⑦ PUMP POWER CONDUIT: (1) 1" C.

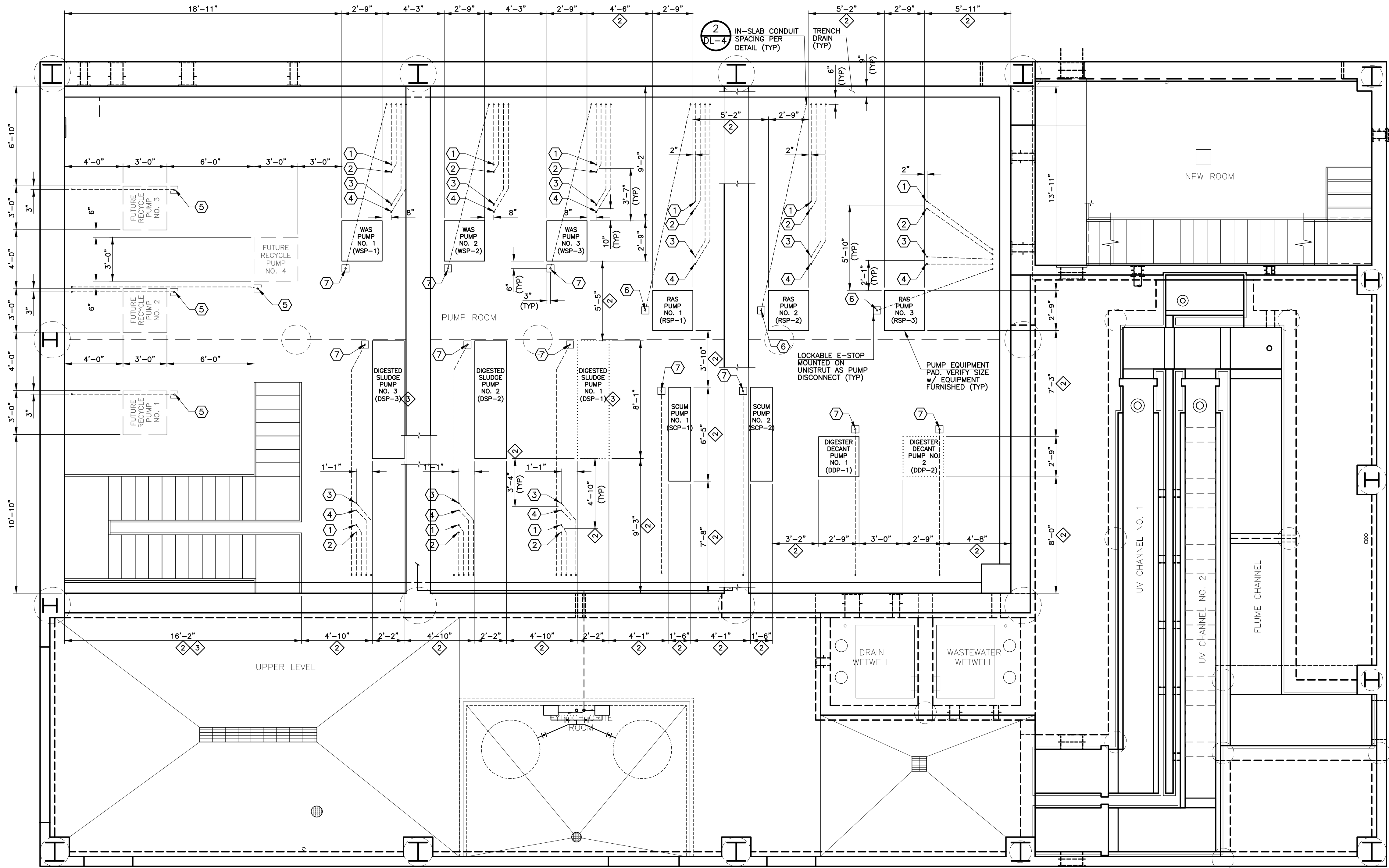

1 PUMPING AND DISINFECTION BUILDING POWER PLAN
EPD-5 SCALE: SCALE: 1/4" = 1'-0"

REVISIONS		
NO.	DATE	DESCRIPTION
1	11/07/2011	ESI #017 PARTIAL PLAN FOR PUMP ROOM SLAB CONDUIT PLACEMENT
2	11/14/2011	REVISED CONDUIT LOCATIONS FOR FINAL FIELD PLACEMENT
3	01/25/2012	ISSUED FOR PD BUILDING VALUE ENGINEERING REVIEW AND COMMENTS
4	04/18/2012	ISSUED FOR BUILDING PERMIT SUBMITTAL TO PPHSD (PUMPING AND DISINFECTION BLDG)
5	05/21/2012	ISSUED FOR CONSTRUCTION PER PPHSD BLDG PERMIT #88993 (PUMP AND DISINFECTION BLDG)

THIS DRAWING IS THE PROPERTY OF GMS, INC., AND IS NOT TO BE RE-PRODUCED, MODIFIED OR USED FOR ANY OTHER PROJECT OR EXTENSION OF THIS PROJECT EXCEPT BY AGREEMENT WITH THIS COMPANY.

© 2010 GMS, INC.

ELECTRICAL FOUNDATION PLAN II
PUMPING AND DISINFECTION BUILDING
HAROLD D. THOMPSON REGIONAL WATER RECLAMATION FACILITY
LOWER FOUNTAIN METROPOLITAN SEWAGE DISPOSAL DISTRICT

DRAWN MAM
DESIGNED MAM/RJS
CHECKED RJS
DATE 2011
PROJECT NO. 20166.330
GMS FILE NO. 2599

GMS, INC.
CONSULTING ENGINEERS
611 N. WEBER, SUITE 300
COLORADO SPRINGS, COLORADO 80903

SHEET
EPD-5
OF
1