

| CURVE TABLE | | | | | |
|-------------|--------------|---------|--------|----------------------------------|----------------------------------|
| CURVE | DELTA | LENGTH | RADIUS | PC | PT |
| C1 | 60° 27' 47" | 46.91' | 44.46' | N = 1287302.25 E = 3238576.33 | N = 1287341.60 E = 3238554.99 |
| C2 | 90° 00' 00" | 25.13' | 16.00' | N = 1287382.38 E = 3238566.68 | N = 1287393.35 E = 3238586.47 |
| C3 | 90° 00' 14" | 31.42' | 20.00' | N = 1287436.21 E = 3238582.11 | N = 1287411.47 E = 3238595.83 |
| C4 | 89° 58' 39" | 78.54' | 50.01' | N = 1287565.01 E = 3238671.07 | N = 1287530.74 E = 3238609.23 |
| C5 | 90° 00' 01" | 78.54' | 50.00' | N = 1287494.62 E = 3238735.17 | N = 1287556.46 E = 3238700.89 |
| C6 | 90° 00' 01" | 31.42' | 20.00' | N = 1287386.38 E = 3238683.33 | N = 1287400.09 E = 3238708.07 |
| C7 | 62° 40' 48" | 54.70' | 50.00' | N = 1287584.98 E = 3238674.63 | N = 1287626.03 E = 3238642.69 |
| C8 | 102° 14' 42" | 26.77' | 15.00' | N = 1287626.03 E = 3238642.69 | N = 1287642.67 E = 3238659.09 |
| C9 | 89° 59' 59" | 23.56' | 15.00' | N = 1287656.13 E = 3238662.95 | N = 1287674.68 E = 3238652.67 |
| C10 | 135° 00' 00" | 35.34' | 15.00' | N = 1287834.23 E = 3238698.42 | N = 1287837.37 E = 3238725.95 |
| C11 | 45° 00' 00" | 39.27' | 50.00' | N = 1287813.35 E = 3238739.27 | N = 1287775.33 E = 3238743.60 |
| C12 | 82° 22' 07" | 50.99' | 35.47' | N = 1287705.64 E = 3238775.63 | N = 1287663.47 E = 3238795.72 |
| C13 | 90° 00' 00" | 47.12' | 30.00' | N = 1287587.53 E = 3238773.95 | N = 1287566.96 E = 3238736.84 |
| C14 | 89° 59' 59" | 23.56' | 15.00' | N = 1287237.30 E = 3238709.24 | N = 1287255.85 E = 3238698.95 |
| C15 | 90° 00' 00" | 23.56' | 15.00' | N = 1287280.20 E = 3238705.94 | N = 1287290.49 E = 3238724.49 |
| C16 | 90° 00' 00" | 15.71' | 10.00' | N = 1287347.62 E = 3238735.67 | N = 1287359.99 E = 3238728.82 |
| C17 | 89° 56' 25" | 78.49' | 50.00' | N = 1287486.07 E = 3238764.97 | N = 1287520.30 E = 3238826.80 |
| C18 | 89° 56' 25" | 78.49' | 50.00' | N = 1287518.93 E = 3238831.61 | N = 1287457.13 E = 3238865.90 |
| C19 | 94° 57' 56" | 16.57' | 10.00' | N = 1287331.85 E = 3238829.98 | N = 1287324.15 E = 3238817.41 |
| C20 | 90° 00' 00" | 23.56' | 15.00' | N = 1287269.81 E = 3238796.59 | N = 1287251.26 E = 3238806.87 |
| C21 | 89° 50' 34" | 23.52' | 15.00' | N = 1287226.91 E = 3238799.89 | N = 1287216.61 E = 3238781.37 |
| C22 | 89° 59' 59" | 15.71' | 10.00' | N = 1287225.26 E = 3238751.21 | N = 1287237.63 E = 3238744.36 |
| C23 | 89° 59' 59" | 15.71' | 10.00' | N = 1287239.83 E = 3238736.67 | N = 1287232.98 E = 3238724.30 |
| C24 | 90° 00' 00" | 78.54' | 50.00' | N = 1287255.04 E = 3238828.76 | N = 1287193.20 E = 3238863.04 |
| C25 | 90° 00' 00" | 78.54' | 50.00' | N = 1287485.90 E = 3238946.97 | N = 1287451.62 E = 3238885.13 |
| C26 | 90° 00' 00" | 78.54' | 50.00' | N = 1287394.29 E = 3239085.07 | N = 1287456.13 E = 3239050.79 |
| C27 | 90° 00' 00" | 78.54' | 50.00' | N = 1287163.43 E = 3238966.86 | N = 1287197.71 E = 3239028.70 |
| C28 | 91° 14' 22" | 23.90' | 15.01' | N = 1287114.75 E = 3239046.53 | N = 1287133.62 E = 3239036.33 |
| C29 | 90° 00' 00" | 7.85' | 5.00' | N = 1287161.50 E = 3239044.33 | N = 1287167.68 E = 3239040.90 |
| C30 | 79° 19' 48" | 69.23' | 50.00' | N = 1287388.77 E = 3239104.29 | N = 1287424.77 E = 3239157.00 |
| C31 | 90° 00' 10" | 78.54' | 50.00' | N = 1287418.09 E = 3239183.44 | N = 1287356.25 E = 3239217.72 |
| C32 | 91° 14' 57" | 23.90' | 15.00' | N = 1287102.47 E = 3239144.96 | N = 1287091.87 E = 3239126.31 |
| C33 | 90° 36' 01" | 31.63' | 20.00' | N = 1287250.04 E = 3238528.74 | N = 1287263.70 E = 3238553.68 |
| C34 | 44° 39' 19" | 38.97' | 50.00' | N = 1287886.48 E = 3238721.60 | N = 1287924.21 E = 3238717.18 |
| C35 | 45° 00' 00" | 39.27' | 50.00' | N = 1287677.67 E = 3238820.60 | N = 1287715.69 E = 3238816.27 |
| C36 | 90° 00' 00" | 78.54' | 50.00' | N = 1287539.40 E = 3238832.96 | N = 1287601.24 E = 3238798.68 |
| C37 | 44° 08' 14" | 39.26' | 50.97' | N = 1287100.68 E = 3239023.03 | N = 1287124.29 E = 3238992.88 |
| C38 | 41° 39' 44" | 43.06' | 59.22' | N = 1287145.58 E = 3238956.54 | N = 1287124.29 E = 3238992.88 |
| C39 | 95° 06' 33" | 83.60' | 50.36' | N = 1287139.41 E = 3238796.64 | N = 1287172.32 E = 3238863.30 |
| C40 | 89° 59' 54" | 23.56' | 15.00' | N = 1287198.50 E = 3238771.98 | N = 1287179.95 E = 3238782.26 |
| C41 | 89° 59' 19" | 23.56' | 15.00' | N = 1287207.51 E = 3238686.13 | N = 1287217.80 E = 3238704.69 |
| C42 | 135° 00' 00" | 70.69' | 30.00' | N = 1287637.82 E = 3238812.29 | N = 1287603.31 E = 3238855.67 |
| C43 | 128° 18' 45" | 42.55' | 19.00' | N = 1287542.28 E = 3238833.79 | N = 1287576.43 E = 3238831.93 |
| C44 | 45° 00' 00" | 23.56' | 30.00' | N = 1287592.30 E = 3238860.56 | N = 1287594.90 E = 3238883.38 |
| C45 | 45° 00' 00" | 23.56' | 30.00' | N = 1287607.81 E = 3238881.91 | N = 1287605.21 E = 3238859.09 |
| C46 | 90° 00' 00" | 78.54' | 50.00' | N = 1287562.25 E = 3239222.16 | N = 1287527.97 E = 3239160.32 |
| C47 | 14° 27' 10" | 12.61' | 50.00' | N = 1287610.28 E = 3239237.58 | N = 1287598.72 E = 3239232.62 |
| C48 | 14° 52' 26" | 8.31' | 32.00' | N = 1287660.48 E = 3239268.33 | N = 1287653.94 E = 3239263.25 |
| C49 | 25° 53' 12" | 9.04' | 20.00' | N = 1287840.43 E = 3239507.50 | N = 1287833.62 E = 3239501.67 |
| C50 | 205° 53' 12" | 53.90' | 15.00' | N = 1287850.84 E = 3239545.09 | N = 1287869.84 E = 3239522.87 |
| C51 | 90° 00' 10" | 109.96' | 70.00' | N = 1287350.73 E = 3239236.95 | N = 1287437.32 E = 3239188.96 |
| C52 | 90° 00' 00" | 54.98' | 35.00' | N = 1287072.64 E = 3239120.80 | N = 1287096.64 E = 3239164.09 |

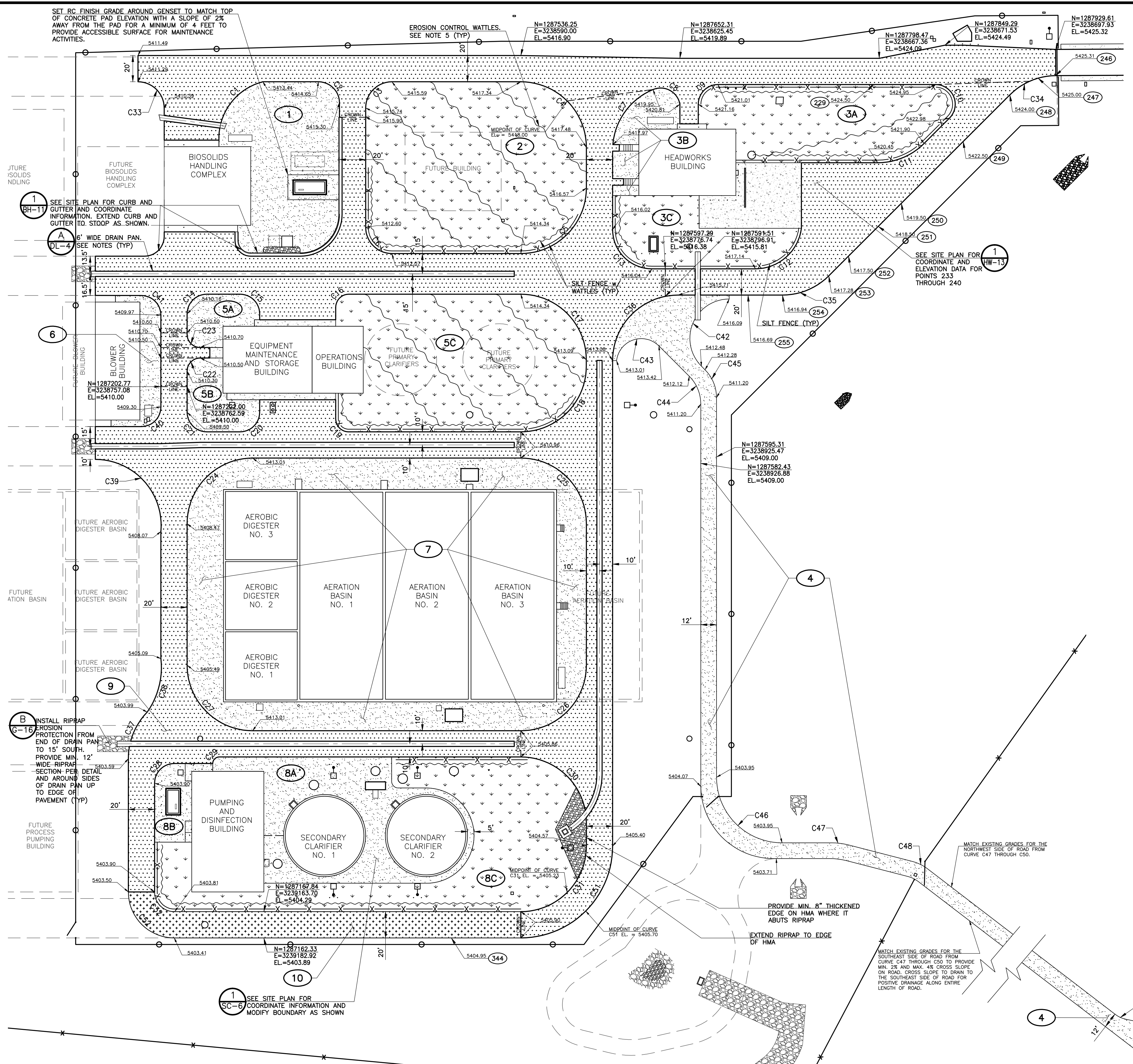

| AREA | SURFACE TREATMENT |
|------|-----------------------------|
| 1 | RC WITH SOIL STERILANT |
| 2 | SEEDING AND EROSION CONTROL |
| 3A | SEEDING AND EROSION CONTROL |
| 3B | RC WITH SOIL STERILANT |
| 3C | SEEDING AND EROSION CONTROL |
| 4 | RC WITH SOIL STERILANT |
| 5A | RC WITH SOIL STERILANT |
| 5B | RC WITH SOIL STERILANT |
| 5C | SEEDING AND EROSION CONTROL |
| 6 | RC WITH SOIL STERILANT |
| 7 | RC WITH SOIL STERILANT |
| 8A | RC WITH SOIL STERILANT |
| 8B | RC WITH SOIL STERILANT |
| 8C | SEEDING AND EROSION CONTROL |
| 9 | HMA |
| 10 | RAP |

SEE NOTES 1 THROUGH 3 FOR ABBREVIATIONS
SEE NOTE 6 FOR SOIL STERILANT REQUIREMENTS

- NOTES:
- HOT MIX ASPHALT (HMA) SURFACING = 5-1/2" FULL DEPTH INSTALLED IN 2 LIFTS.
 - RECLAIMED ASPHALT PAVEMENT (RAP) SURFACING = 5-1/2" FULL DEPTH
 - RECLAIMED CONCRETE (RC) SURFACING = 6" FULL DEPTH
 - DRAIN PANS CONSTRUCTED PER SECTION A/DL-4 WITH THE FOLLOWING AMENDMENTS:
A. WIDTH OF DRAIN PANS = 6'-0"
B. CONCRETE MIX TO INCLUDE FIBER REINFORCEMENT PER SPECIFICATION SECTION 03200
C. DISCHARGE END OF DRAIN PANS TO BE CONSTRUCTED WITH A REINFORCED THICKENED EDGE PER SECTION C/BH-3
 - STRAW WATTLES SHALL BE PLACED PERPENDICULAR TO GROUND SLOPE WITH ROW SPACING NO MORE THAN 50' DOWN SLOPE. ROWS SHALL BE PLACED WITH CONTINUOUS RUNS OF STRAW WATTLES AS SHOWN.
 - SOIL STERILANT SHALL BE A NON-SELECTIVE, WATER-SOLUBLE, PRE AND POST EMERGENT HERBICIDE, HYVAX® X-L BY DUPONT™ OR EQUIVALENT. IT SHALL BE APPLIED TO THE SUBGRADE MATERIAL FOLLOWING FINAL GRADING AND WITHIN 72 HOURS PRIOR TO PLACING SURFACING MATERIAL. LIGHTLY WORK TOP 3"± OF SUBGRADE PRIOR TO APPLICATION TO ALLOW STERILANT TO PENETRATE PAST THE SURFACE. APPLY STERILANT AT MAXIMUM RATE RECOMMENDED BY MANUFACTURER AND IN STRICT ACCORDANCE WITH THEIR INSTRUCTIONS, INCLUDING PRE AND POST APPLICATION WATERING REQUIREMENTS. RECOMPACT TOP 3"± IMMEDIATELY PRIOR TO PLACING FINAL SURFACING. EXTREME CARE SHALL BE USED WHEN APPLYING STERILANT TO AVOID RUNOFF, OVERSPRAY OR ANY OTHER DAMAGE TO ADJACENT AREAS, VEGETATION, ANIMALS, STRUCTURES AND EQUIPMENT, ESPECIALLY ALUMINUM MATERIALS. ALL DAMAGES CAUSED BY THE STERILANT OUTSIDE THE REQUIRED AREAS WILL BE THE SOLE RESPONSIBILITY OF THE CONTRACTOR AND SHALL BE CORRECTED AT HIS EXPENSE.
 - SEE SHEET G-2 AND G-3 FOR COORDINATE INFORMATION.
 - FINISH GRADE ELEVATIONS GIVEN ON THIS DRAWING ARE AT THE PC OR PT OF THE CURVES SHOWN UNLESS OTHERWISE NOTED WITH A COORDINATE NUMBER OR SPECIFIC NORTHING AND EASTING. ROADWAYS WITH DRAIN PANS SHALL BE GRADED WITH A MINIMUM 2% CROSS SLOPE FROM EDGE OF PAVEMENT TO EDGE OF DRAIN PAN. SEE DETAILED SITE PLANS OF NEAR-BY BUILDINGS FOR FINISH GRADES AT STOOPS AND APRONS AROUND BUILDINGS.
 - FINAL GRADES SHALL PROVIDE POSITIVE DRAINAGE THROUGHOUT THE ENTIRE SITE. MINOR ADJUSTMENTS TO ELEVATIONS GIVEN ON THIS DRAWING MAY BE REQUIRED TO ACCOMMODATE AS-CONSTRUCTED ELEVATIONS OF DRAIN PANS AND OTHER FLATWORK AND GRADING.

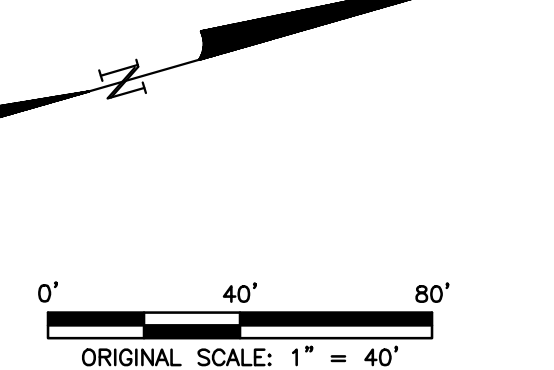

| REVISIONS | | |
|-----------|------------|--|
| NO. | DATE | DESCRIPTION |
| 1 | 04/16/2013 | ISSUED FOR HORIZONTAL LAYOUT |
| 2 | 04/29/2013 | ISSUED WITH ADDITIONAL VERTICAL LAYOUT INFORMATION |

THIS DRAWING IS THE PROPERTY OF GMS, INC., AND IS NOT TO BE REPRODUCED, MODIFIED OR USED FOR ANY OTHER PROJECT OR EXTENSION OF THIS PROJECT EXCEPT BY AGREEMENT WITH THIS COMPANY.

SITE SURFACING PLAN
HAROLD D. THOMPSON REGIONAL WATER RECLAMATION FACILITY
 LOWER FOUNTAIN METROPOLITAN SEWAGE DISPOSAL DISTRICT

| | |
|--------------|-----------|
| DRAWN | MAM/MAL |
| DESIGNED | MAM |
| CHECKED | RUS |
| DATE | 2013 |
| PROJECT NO. | 20166.325 |
| GMS FILE NO. | 2599 |

GMS, INC.
 CONSULTING ENGINEERS
 611 N. WEBER, SUITE 300
 COLORADO SPRINGS, COLORADO 80903

SHEET **G-51** OF **1**